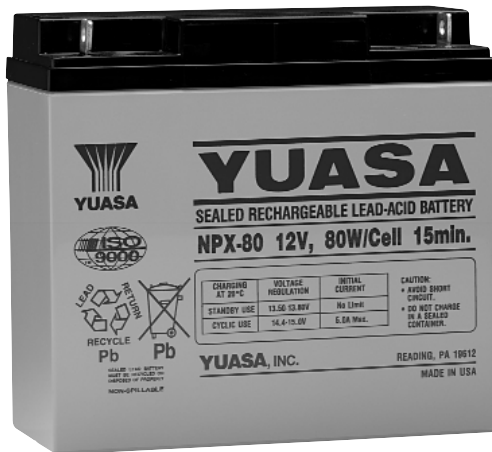

Independence™**SEALED RECHARGEABLE LEAD-ACID****B A T T E R I E S**

YUASA
 Power/Full Solutions™
**NPX-80
NPX-80FR****12V, 80W/Cell-15 min****Specifications****NOMINAL VOLTAGE:** 12V**NOMINAL WATTAGE/CELL**

15 min. discharge rate to 1.67V/cell 80
 10 min. discharge rate to 1.67V/cell 104
 5 min. discharge rate to 1.67V/cell 140

NOMINAL CAPACITY

10 hour rate of 2.0A 20.0Ah
 5 hour rate of 3.7A 18.5Ah
 1 hour rate of 14.5A 14.5Ah

WEIGHT (approx.) 14.5 pounds (6.6 kgs.)**ENERGY DENSITY (10 hr. rate):**

1.71 WH/cubic inch (104 WH/liter)

SPECIFIC ENERGY (10 hr. rate):

16.6 WH/pound (36.5 WH/kg)

INTERNAL RESISTANCE OF CHARGE:

7 milliohms (approx.)

MAXIMUM DISCHARGE CURRENT**WITH STANDARD TERMINALS:**

100 amperes

MAXIMUM SHORT-DURATION**DISCHARGE CURRENT:**

450 amperes

OPERATING TEMPERATURE RANGE:**CHARGE** 5°F to 122°F

(-15°C to 50°C)

DISCHARGE -4°F to 140°F

(-20°C to 60°C)

CHARGE RETENTION (shelf life) at 68°F (20°C):**1 month** 97%**3 months** 91%**6 months** 85%**LIFE EXPECTANCY:****STANDBY USE** 3 to 5 years**CYCLE USE (approx.)****100% depth of discharge** 250 cycles**50% depth of discharge** 550 cycles**30% depth of discharge** 1200 cycles**SEALED CONSTRUCTION:**

Can be operated in any position without leakage.

STANDARD TERMINAL:

Bolt Fastened Terminal

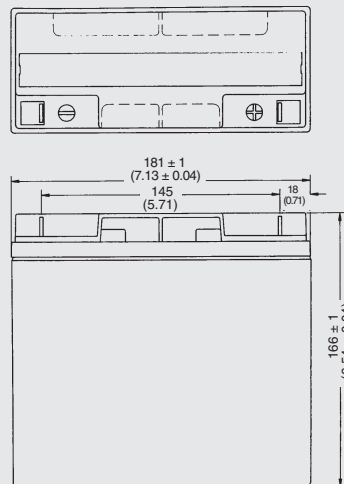
HOUSING MATERIAL: ABS Resin**OPTIONAL:** Container and cover made from Flame Retardant ABS (UL94-VO/L.O.I.>28%)**HARDWARE:** 2-M5-.8 x 12mm Bolt w/nuts, lock washer & flat washer**Dimensions**

DIMENSIONS: MM (INCHES)

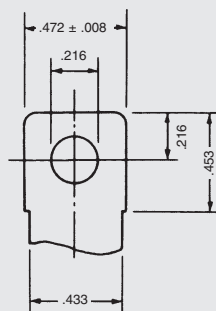
Terminal**INCH = MM**

.472 12.00

.453 11.50

.433 11.00

.216 5.50

.079 2.00

DIMENSIONS: INCHES



RECOGNIZED BY UL, File No. MH 16464

NPX-80 CONSTANT WATTAGE - TYPICAL RUN TIMES (Watts/Cell)

V/CELL	5 min.	10 min.	15 min.	20 min.	30 min.	40 min.	50 min.	60 min.
1.75	136	102	78	63	42	37	31	25
1.70	138	103	79	64	43	38	32	25
1.67	140	104	80	65	43	38	32	25
1.60	145	106	81	66	44	39	33	26
1.50	148	109	83	68	45	40	33	26

SELF DISCHARGE CHARACTERISTICS

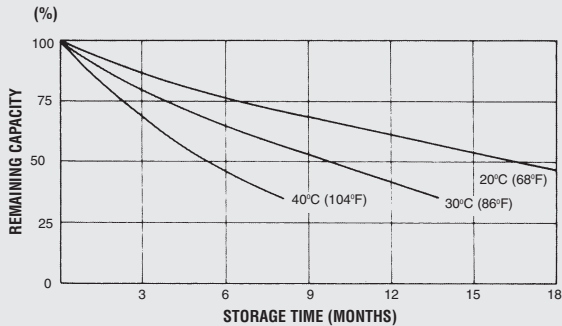

OPEN CIRCUIT VOLTAGE VS REMAINING CAPACITY

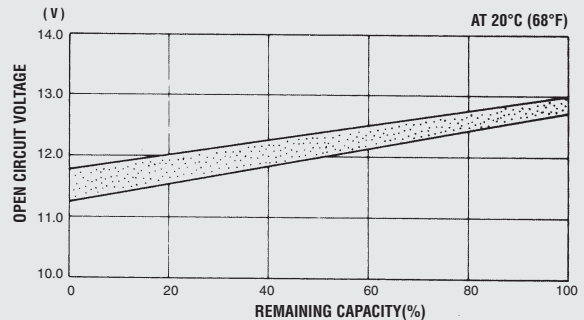

CYCLE SERVICE LIFE IN RELATION TO DEPTH OF DISCHARGE

TESTING CONDITIONS: DISCHARGE CURRENT: 0.17C AMP. (F.V. 1.7V/CELL)
CHARGING CURRENT: 0.09C AMP.
CHARGING VOLUME: 125% OF DISCHARGED CAPACITY
AMBIENT TEMPERATURE: 20°C TO 25°C (68°F TO 77°F)

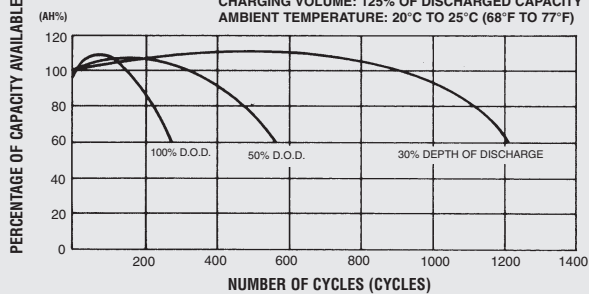

FLOAT SERVICE LIFE

TESTING CONDITIONS: FLOATING VOLTAGE 2.25 TO 2.30V/CELL
AMBIENT TEMPERATURE: 20°C TO 22°C (68°F TO 72°F)

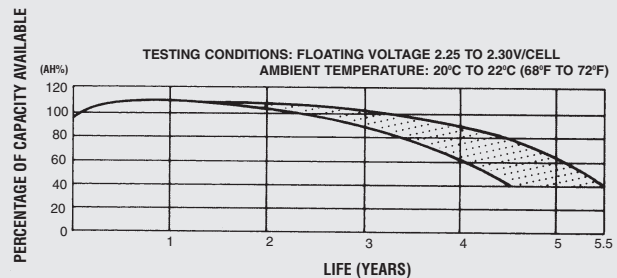

When the battery will be used by the current in excess of 3C, consult with Yuasa, Inc. prior to use.

CHARGING METHODS (At 20°C) Cycle use: Maximum charging current 5.0A
Charging voltage 14.4 to 15.0V

Standby use: Float charging voltage 13.50 to 13.80V

CAUTION

- Avoid short circuit
- Do not charge in a sealed container.

Represented by:



Power/Full Solutions™

Sales Offices

Eastern Region: 201-964-0118 • 1-800-962-1287
FAX 201-964-0720

Western Region: 562-949-4266 • 1-800-423-4667
FAX 562-949-5527

Corporate Office: P.O. Box 14145, Reading, PA 19612-4145
FAX 610-372-8613

Visit us on the web at: www.yuasastationary.com

Please check our website for literature updates

When ordering new batteries, also remember to properly recycle your old lead batteries. Federal and state regulations require lead-acid batteries be recycled. Yuasa's nationwide service organization can arrange pickup, transportation to and recycling at any one of our company affiliated smelters. Call 1-800-972-7372 for more information.

